The top section of the cover features five overlapping circles in shades of light purple and white. The text 'OLLI @ Furman University' is centered within one of the white circles.

*OLLI @ Furman University*

# Membership Handbook

**2009-2010**



## **OLLI @ Furman University**

3300 Poinsett Highway  
Greenville, SC 29613-1511

Phone: 864-294-2998  
E-mail: [olli@furman.edu](mailto:olli@furman.edu)

## **What's Inside**

- Important term dates
- Frequently asked questions
- Benefits of membership
- History of OLLI @ FU
- Listing of Committees

**Contact Number: 864-294-2998**



**OLLI @ Furman Contacts**

**Dr. Brad Bechtold 294-3136** *brad.bechtold@furman.edu*  
Furman University Continuing Education Director

**Lucy Woodhouse 294-2997** *lucy.woodhouse@furman.edu*  
OLLI Director

**Carol Armstrong 294-2979** *carol.armstrong@furman.edu*  
OLLI Department Assistant: Membership

**Tracey Hendricks 294-2998** *tracey.hendricks@furman.edu*  
OLLI Department Assistant: Committees

**Barbara Mallon 294-2998** *barbara.mallon@furman.edu*  
OLLI Department Assistant: Instructors

---

**OLLI @ Furman Mission Statement**

OLLI @ Furman is a diverse community of seasoned learners engaged in classes and activities that enhance the successful aging process. OLLI @ Furman inspires students to stay intellectually and physically active through its many opportunities for lifelong learning, well-being, personal connection, creativity and enjoyment.





### 2009-2010 OLLI Council

<b>Alan Weinberg</b> - President	<b>Joy Eaton</b> - At Large
<b>Sherm Rounsville</b> - Vice President	<b>Jim Baker</b> - At Large
<b>Shirley Hicks</b> - Secretary	<b>Judy Brooks</b> - At Large

#### Committee Chairs

Admin & Governance: Karl Sedlarz	Membership: Sherm Rounsville
Building Solicitation: Bob Howell	Newsletter Editor: Gary Aten
Curriculum: Dan Kappel	Publicity: Barbara Leimsieder
Long Range Planning: Gladys Spiak	Special Events: Judy Aten and Carol Gemlick

---

#### OLLI @ Furman member benefits:

- OLLI members can buy lunch in the Furman Faculty dining room, located in the lower level of the student dining hall. (See Map, page 7, I.) We ask that you eat at one of the tables in the alcoves overlooking the lake in the student dining area. Full menus for under \$5.
- Members have access to the Furman University Duke Library and OLLI Book Nook (located in the OLLI Office building).
- Opportunities to take special trips and attend events coordinated by the Special Events committee to theatres, museums, and a variety of other activities.
- Brown Bag lunch speakers, and special prices for campus events
- OLLI members will receive the weekly **OLLI Notes** and the quarterly newsletter, **Gray Matters**, which keeps you updated on all OLLI and campus events.
- Use of computer lab when not in use by a class
- Early notice of course brochures



**Contact Number: 864-294-2998**

## **Welcome to OLLI @ Furman**

OLLI @ Furman gives you more than just something to do. You may begin by attending Dr. Crabtree's Shakespeare course, which leads to a Pen and Ink class, add a Brown Bag Luncheon on Tuesday and then a tour on Friday, and along the way you realize that learning never retires and you've never felt better or so engaged.

In addition to the many courses that are offered during the academic year, various committees will plan special programs that include social events, discussion groups, special interest clubs, travel and service opportunities. These programs are planned around your interests and with your participation, so please let the Curriculum Committee know what types of programs you want offered.

Don't hesitate to ask questions, share your life experiences, get involved with a committee and take that biology class you avoided when you were a teen. The more involved you become, the richer and fuller OLLI @ Furman becomes, and the richer and fuller your life becomes.

This special handbook contains some useful information that will help you better enjoy your experience as part of OLLI @ Furman. And remember, **learning never retires!**



Director, OLLI@ FU



## History of OLLI @ Furman

When OLLI began in 1993, there were seven courses offered and 62 members. At the time it was called Furman University Learning In Retirement (FULIR). Currently, there are approximately 80 classes per term and over 600 members making new friends and pursuing educational interests on the Furman campus.

Furman's Learning In Retirement Program (FULIR) was renamed the **Osher Lifelong Learning Institute at Furman (OLLI @ Furman)** in 2008 in response to a grant from the Bernard Osher Foundation, a San Francisco based philanthropic organization. The initial grant of \$100,000 was made in February 2008, and it was the first in a series of grants that will provide more than \$2.2 million to the program. The Osher Foundation supports 122 Osher Lifelong Learning Institutes on university and college campuses across the country including four in South Carolina—Furman, Clemson, Coastal Carolina and USC-Beaufort. OLLI @ Furman offers senior adult learners classes and activities that stimulate the successful aging process.

### **A Home of Our Own**

The success of our classes and a growing membership has us bursting at the seams! Our dream of a new building that will contain classrooms, a computer lab, kitchen, lobby/living room, offices and storage is turning towards reality. The building will be built on Furman's campus and will provide a permanent home for OLLI @ Furman. The preliminary cost estimate for the 16,000 square foot building is an estimated \$6 million. Thanks to the Bernard Osher Foundation and some generous gifts from our membership we have \$2.15 million pledged. Can you help make this

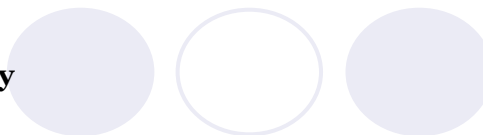

## Where are the OLLI classrooms?

*Map Reference A.* **OLLI Office (OO) 107, 109, 110 and 116** are in the OLLI Office building, located behind McAlister Auditorium, adjacent to the Playhouse. Parking is available in front of the OLLI building.

*Map C.* The **Bryan Garden Room (BGR)**, **Chapel Meeting Room (CMR)**, and the **Humphries Conference Room (HCR)** are located on the lower level of the Charles E. Daniel Chapel. Enter from the side entrance on the right hand side of the building. The building is most accessible from the ground level on the back of the building.

*Map F.* **Hipp Hall (HH) (Map F)** is located next to the library. Students should park beside the chapel and walk past Plyler Hall, *Map H.* **Rinker Hall (RH)** and the Riley Hall toward the library. Turn left in front of the library. Hipp Hall will be on your left as you walk toward the lake. Room 7 is located on the bottom floor.

*Map D.* The **Dance Studio (DS)** is upstairs in the **Lay Physical Activity Center (PAC)**. The PAC is at the end of the tree lined mall and is the building facing you when you approach the 2nd roundabout. Parking for the PAC is to the left of the building. The steps to the second floor are located in the hallway on the right as you enter the front of the building. The pool is accessed through the exercise room.

*Map K.* **North Village (NV), Building J**, can be reached by taking the 2nd right from the 1st roundabout at the entrance, drive under the walking bridge and take the next right. Look for Building “J”, toward the back part of the NV complex. Once you park, walk to the right or left of the building towards the apartments. There is an elevator on the back side as well as stairs on the front side (be sure to enter the doors on the right side) to get to the second and third levels. When you get out of the elevator, you will need to walk across the bridge back to the building.

*Map J.* **Furman Hall (FH)** is the first building on the right when taking the 5th right off the roundabout from the main entrance. Students should park in the parking lot to the left of the chapel about midway in the parking lot. Then walk through the hedges towards the main campus. Furman Hall will be straight ahead of you.

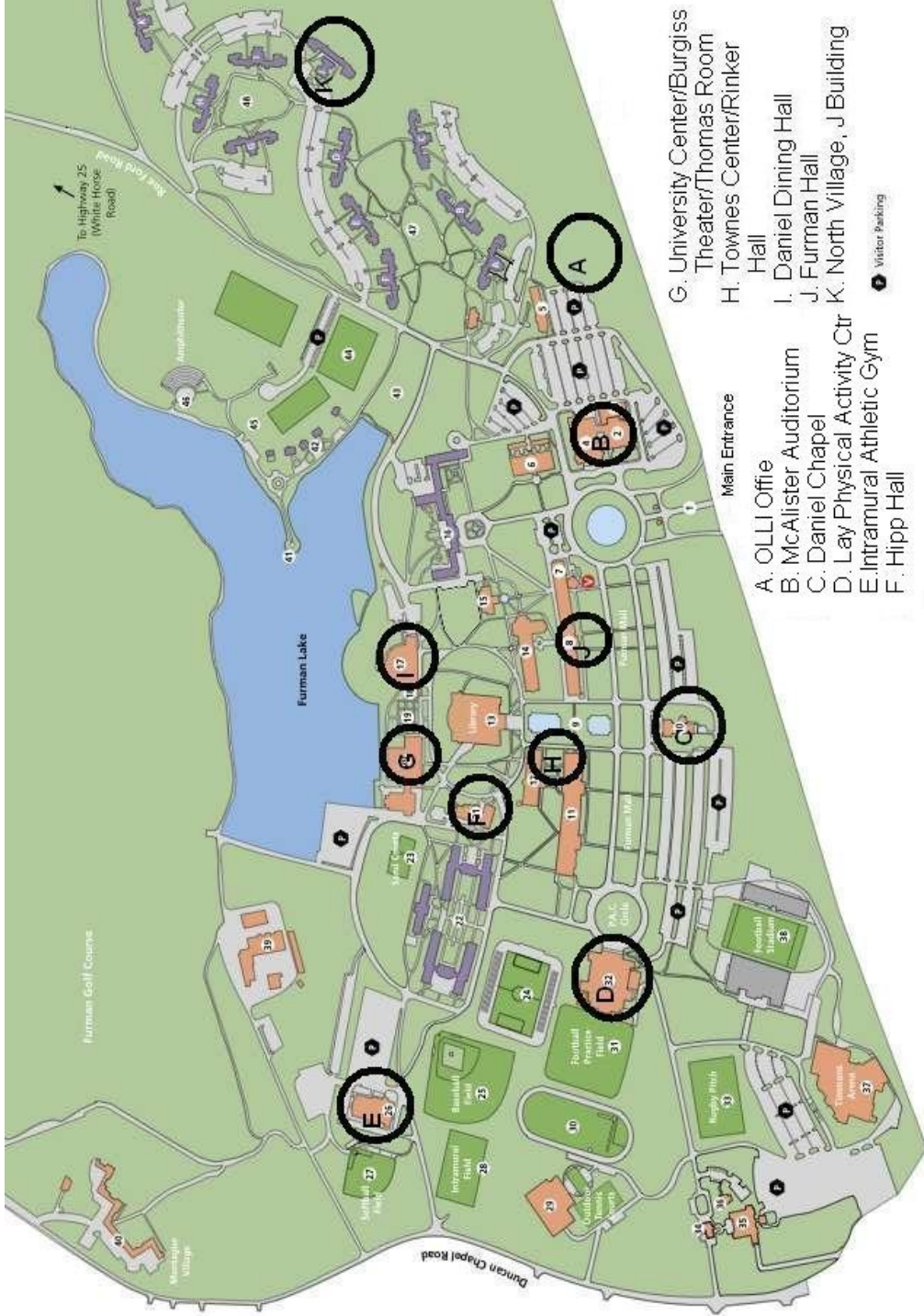

- A. OLLI Office
- B. McAlister Auditorium
- C. Daniel Chapel
- D. Lay Physical Activity Ctr
- E. Intramural Athletic Gym
- F. Hipp Hall
- G. University Center/Burgiss Theater/Thomas Room
- H. Townes Center/Rinker Hall
- I. Daniel Dining Hall
- J. Furman Hall
- K. North Village, J Building

Visitor Parking

Main Entrance

Furman Golf Course

Furman Lake

To Highway 25 (White Horse Road)

Duncan Chapel Road

McAlister Amphitheater

Amphitheater

Spring Center

Library

Phy. C. Center

Phy. C. Center

Phy. C. Center

Phy. C. Center

Phy. C. Center

Phy. C. Center

Phy. C. Center

Phy. C. Center

Phy. C. Center



**Contact Number: 864-294-2998**

## **OLLI at Furman Committees**

### **Administration and Governance Committee:**

The Administration and Governance Committee decides on the length of each term (ten weeks, eight weeks, etc.), membership fees, and other administrative decisions. They meet only when there is a decision about changing the current fees, term lengths, etc generally once per term.

### **Curriculum Committee:**

The Curriculum Committee by reviewing the information on the evaluation sheets from the previous term seeks competent instructors to teach a well-balanced variety of classes for the next term. Having a large committee helps because each person may know of one or two people who are experienced in a particular field. This committee usually meets three or four times in a term to plan the courses for the following term.

### **Long-Range Planning Committee:**

The Long-Range Planning Committee consists of the former presidents of OLLI @ Furman and other interested members. They have established an endowed fund, the *interest* from which will provide a modest income for scholarships and other financial needs. They also consider the needs and goals of OLLI @ Furman for three, five, and ten years into the future. This committee meets about once per term.

### **Membership Committee**

The Membership Committee works to recruit new members, increase retention of existing members, and involve interested members in projects, committees and activities. They communicate with class liaisons, personally call new members before the term begins and again at the end of their first term, set up an orientation program for new members, and survey existing members to identify needs and interests of members.



**Gray Matters Editor:**

**Gray Matters** is produced four times an academic year. The editor oversees collecting articles and information from the membership and committees, assembles it and turns the newsletter in to the office for printing and distribution.

**Publicity Committee:**

The Publicity Committee helps to distribute the newly printed brochures each term to a wide variety of locations around Greenville library and its branches, book stores, churches, retirement homes, etc.), and sends out news releases, etc. to let people know about the upcoming classes. They also help with talks to community groups, ways to publicize OLLI @ Furman on campus, and make decisions on promotional ideas. The committee meets once a month.

**Special Events Committee:**

Special Events plans our Brown Bag luncheon speakers, the luncheon at the end of the year to honor our class instructors, outings to the theater, restaurants, trips, and all other social activities for the OLLI @ FU members. They meet two to three times each term.

---

**Free audit program for Senior Citizens at Furman**

As a service to Greenville area senior citizens, Furman permits anyone 60 and over to audit day or evening credit classes on a space-available basis at no charge. The program gives seniors the opportunity to enjoy the stimulation of a serious academic environment without the cost of taking courses for credit.

If you qualify and are interested, contact the Continuing Education Department in Hipp Hall or call 864-294-2155. Because free audits are only permitted on a space-available basis, requests cannot be confirmed until after regular student registration is completed each term.



**Contact Number: 864-294-2998**

## FAQs (Frequently Asked Questions)

**What happened to FULIR?** FULIR got a new name because of a generous donation by the Bernard Osher Foundation. One of the very few requests from the foundation was for the program to be renamed the Osher Lifelong Learning Institute at Furman, otherwise known as OLLI @ Furman. We join 122 OLLI programs across the country in a unique networking partnership of senior lifelong learning programs that are associated with a college or university. OLLI is “fulir” because of this partnership!

**What is Learning for You? How does it differ from OLLI @ Furman?** The mission of Learning for You (our sister division within FU’s Continuing Education Department) is to provide a broad array of educational classes, trips, and programs for children, young people, and adults in the Upstate community with the majority of classes being held evenings and weekends. OLLI @ Furman is a diverse community of seasoned adult learners engaged in classes and activities that enhance the successful aging process. OLLI @ Furman inspires students to stay intellectually and physically active through its many opportunities for lifelong learning, health and well-being, personal connection, creativity, and enjoyment.

**How do I learn about member activities or class changes throughout the term?** We communicate to the membership in through our quarterly newsletter, **Gray Matters**, which consists of committee reports, member profiles and the building campaign donor reports. Our weekly news, **OLLI Notes**, is distributed every Friday. Both of these publications are delivered via email in our efforts to reduce paper and copying costs. If you don’t have email, copies of both publications will be made available in the OLLI office, the Chapel, or North Village. Important announcements will also be made through instructors and class liaisons.

**Can my spouse join me on a Friday trip or Event Tour?** Yes, but only after he/she joins OLLI for the annual \$25 membership fee.



**Can I register online?** Not yet, but you can view the brochure online and print out the registration forms to be mailed or brought to the office. Our website is [www.furman.edu/olli](http://www.furman.edu/olli).

**Do you provide scholarships?** Yes. We don't want students denied the opportunity to continue learning. Contact Lucy Woodhouse for more information at 294-2997 or via email [lucy.woodhouse@furman.edu](mailto:lucy.woodhouse@furman.edu).

**What is the wait list policy?** If you sign up for a class that is full, you will be automatically put on a waiting list. We are limited by classroom sizes, time available to us, instructor comfort levels, and safety. If a class has a long waiting list, the curriculum committee works to secure the course for future terms. Please be patient if you are put on a waiting list; many times, we are able to open/move a class to handle the demand.

**Can I volunteer?** Of course! Our goal is to have participation from all members. We believe that the more people involved the better quality programming and services we will be able to provide. Whether you are shelving books, answering the phone, serving on a committee, making coffee or giving directions, it takes us all to make OLLI special! Stop by the office to get involved.

**How do I sign up to be a liaison?** You can call the OLLI Office and sign up, check the box on the registration form, or approach your instructor in class and offer to be the class liaison. It is easy and a great way to get involved.

**How can I make suggestions to improve the program?** OLLI is member-led, that means that the activities, programs and procedures are primarily directed by the members. If you have ideas for improving the program talk to the Director, any of the Board or committee members or submit your idea through our online suggestion box. We can only get better with an engaged membership. Ideas are always welcome!!



## **Fall Semester 2009**

Brochure mailed out July 17, posted on the web July 22

Registration begins August 10

Classes begin September 14, run through Nov. 20 (10 weeks)

Welcome Coffee September 13 from 2:00-3:30 p.m.

FU Students semester: August 26-December 17th

## **Winter Semester 2010**

Brochure mailed and posted on the web November 10

Registration begins November 16

Classes begin January 11, run through March 5 (8 weeks)

Welcome Coffee January 10 from 2:00:-3:30 p.m.

No class Monday, January 18 (MLK, Jr. Holiday)

FU Students semester: January 11-May 6

Spring Break March 6-14

## **Spring Semester 2010**

Brochure mailed and posted on the web February 8th

Registration begins February 15

Classes begin March 22 run through May 14 (8 Weeks)

Welcome Coffee March 21<sup>st</sup> from 2:00:-3:30 p.m.

No class Friday, April 2 (Good Friday)

OLLI Celebration Luncheon, Tuesday, May 18

